



PARAMOUNT
HOUSING ASSOCIATION
TASMANIA

132 Davey Street, Hobart 7000
Postal: GPO Box 401, Hobart Tas 7001
Ph: (03) 6220 0222 Fax: (03) 6220 0233
Website: www.paramountgroup.com.au

Site Address:

**PROPOSED STAGE 1 PLAN FOR
MALGONA HEIGHTS, BURNIE**

View: SITE PLAN - LOT 1 SUBDIVISION LAYOUT		
Drawn by: MK	Amended:	Sheet No: 1
Date: 03/03/10	Scale: 1:1500	

COPYRIGHT ©

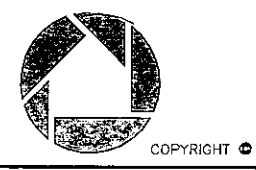
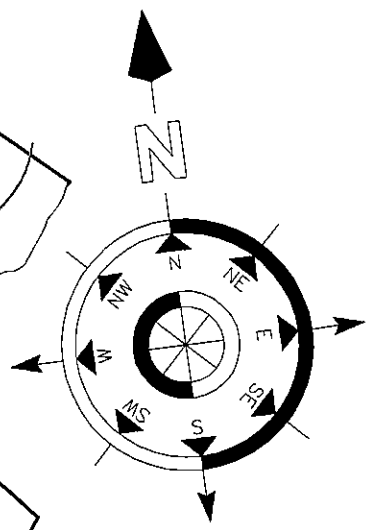

PARAMOUNT
HOUSING ASSOCIATION
TASMANIA

132 Davey Street, Hobart 7000
Postal: GPO Box 401, Hobart Tas 7001
Ph: (03) 6220 0222 Fax: (03) 6220 0233
Website: www.paramountgroup.com.au

Site Address:

**PROPOSED STAGE 1 PLAN FOR
MALGONA HEIGHTS, BURNIE**

View: **SITE PLAN -- LOT 1: SUBDIVISION LAYOUT**

Drawn by: MK	Amended:	Sheet No: 1
Date: 03/03/10	Scale: 1:1500	

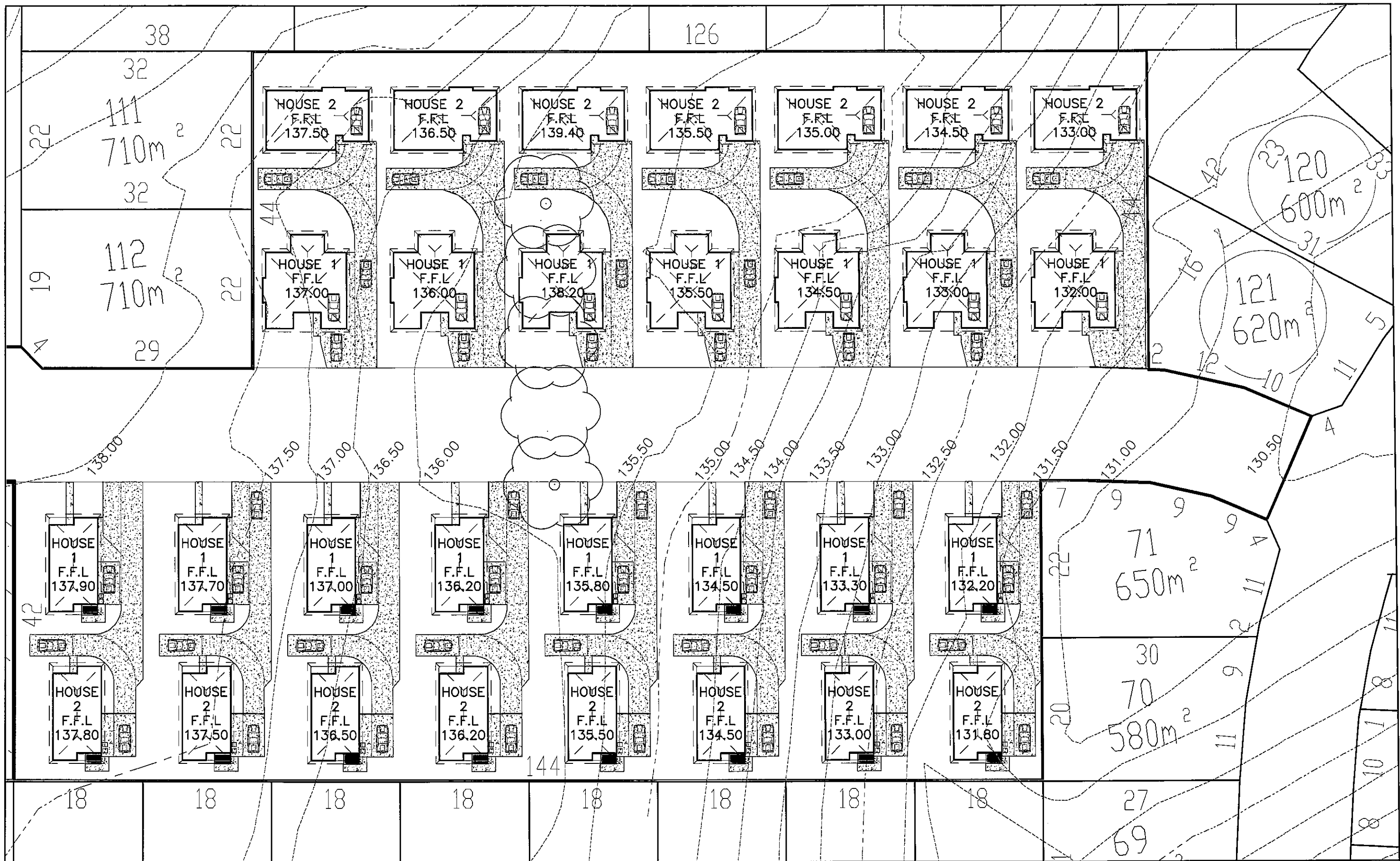

General:

- Builder to verify all dimensions and levels on site prior to commencement of work.
- All work to be carried out in accordance with the;
 - Building Code of Australia.



COPYRIGHT ©

**PARAMOUNT
HOUSING ASSOCIATION
TASMANIA**

132 Davey Street, Hobart 7000
 Postal: GPO Box 401, Hobart Tas 7001
 Ph: (03) 6220 0222 Fax: (03) 6220 0233
 Website: www.paramountgroup.com.au

Site Address:

**PROPOSED NEW DWELLINGS
AT LOT 1 MALONGA
HEIGHTS, BURNIE**

View:

SITE PLAN

Drawn by: **MICHAL KONIK**

Sheet No:

Date: **08/04/10**

Amended:

Scale: **1:600**

Job No:

Sign by Manager:

1

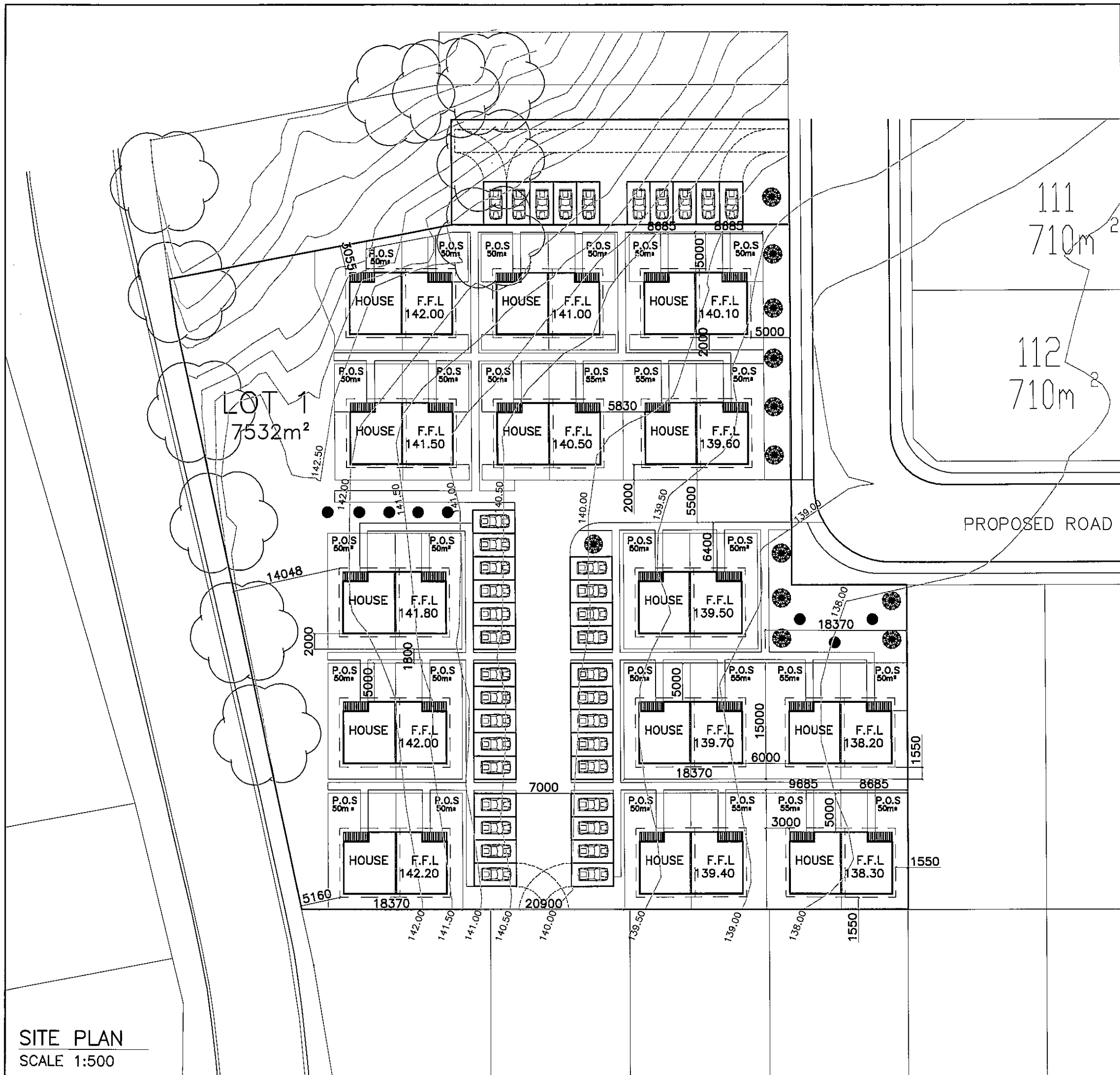

General:

- Builder to verify all dimensions and levels on site prior to commencement of work.
- All work to be carried out in accordance with the:
 - Building Code of Australia.

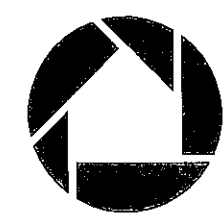
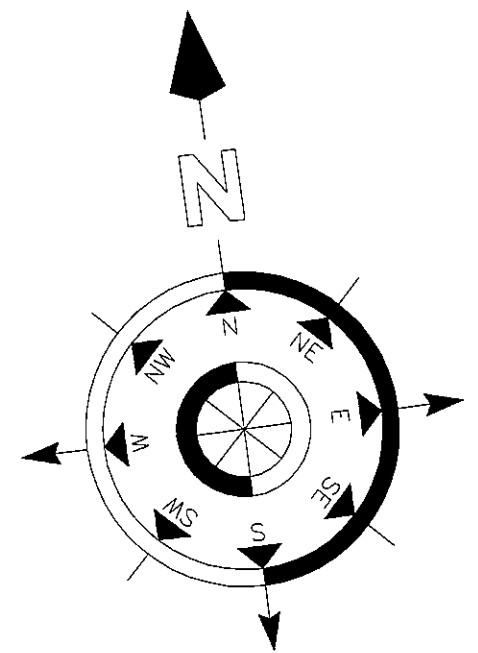

**PARAMOUNT
HOUSING ASSOCIATION
TASMANIA**

132 Davey Street, Hobart 7000
 Postal: GPO Box 401, Hobart Tas 7001
 Ph: (03) 6220 0222 Fax: (03) 6220 0233
 Website: www.paramountgroup.com.au

COPYRIGHT ©

Site Address:

**PROPOSED NEW DWELLINGS
AT LOT 1 MALONGA HEIGHTS,
BURNIE**

View: **SITE PLAN**

Drawn by: MICHAL KONIK	Sheet No:
Date: 08/04/10	Amended:
Scale: 1:500	Job No:
Sign by Manager:	1

SITE PLAN
SCALE 1:500